

Metering gear pumps

4610-1-1

Application fields

Silicones, glues, elastomers, polyurethanes, various resins, various hardeners, pigments, epoxy, polyesters, etc...

Strong points

- All parts are in tempered stainless steel
- Reduction of "dead zones" allowing for a better flushing
- New sealing technology combining lip seals and liquid barrier
- Sealing options quickly interchangeable
- Strong, coated drive shaft, held in place with 2 bearings and a axial thrust
- Centering pins making pump assembly easier and increasing its accuracy

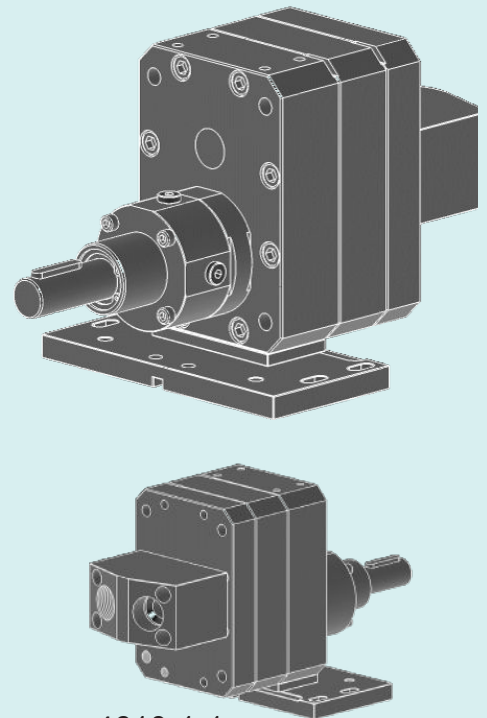

4610-1-1

Technical data

| | |
|---------------------------------|--|
| Sealing : | Lip seals and liquid barrier |
| Rotation speed : | From 10min ⁻¹ to 200min ⁻¹ , depending on the product involved |
| Standard rotation : | Clockwise rotation (A) |
| Temperature : | Max. 135°C |
| Output pressure : | Max. 100 bars (100cc/rev = max. 50 bars) |
| Input/Output : | 2 holes Ø 15mm on the rear of the pump. Delivered with connecting block G1" |
| Driving shaft diameter : | Ø25mm with a 8mm key |
| Drive shaft height : | H=79mm |

Available outputs

35.0cc/rev 50.0cc/rev 70.0cc/rev 100.0cc/rev

Options

- (T2) Entirely treated with ADLC
- (H135) Stand H=135mm
- (Z) Counterclockwise rotation
- (AZ) Clockwise and counterclockwise rotation

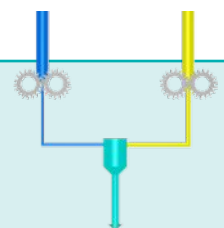

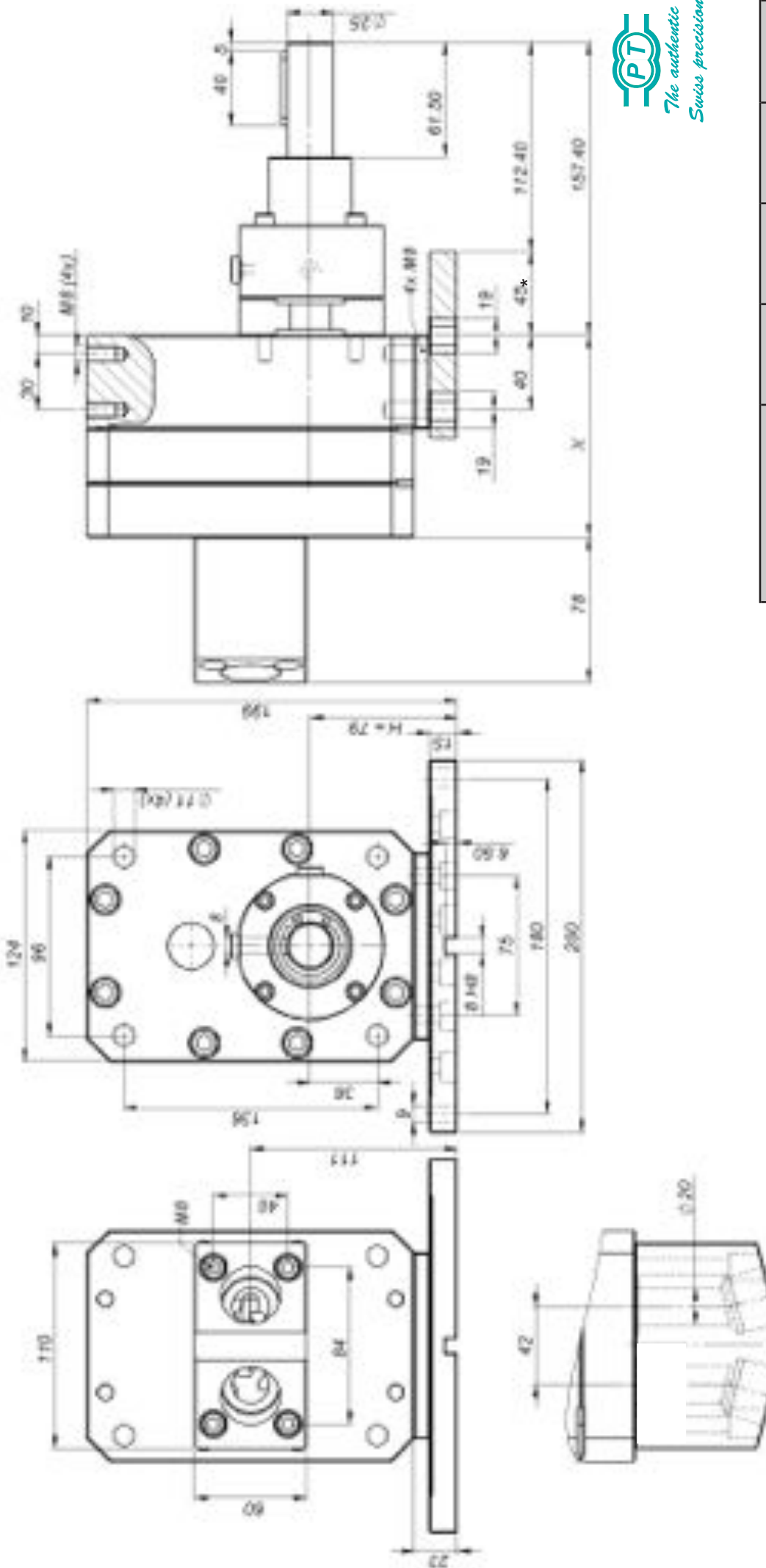

| Outputs (cc/rev) | 35.0 | 50.0 | 70.0 | 100.0 |
|------------------|------|-------|--------|-------|
| X (mm) | 99.5 | 108.3 | 119.98 | 137.6 |